

Airsoft Certification

Self Assessment Exam AEG01, Version 1 Part II

ANSWERS

Proudly presented by the AirsoftPRESS

Airsoft Certification AEG01 V1 – Part II - Answers

Question 41:

Refer to the exhibit below:



The part shown is essential for which of the following purposes?

- A. select fire**
- B. hopup
- C. barrel tuning
- D. piston adjustment
- E. None of the choices.

Airsoft Certification AEG01 V1 – Part II - Answers

Question 42:

For smoother piston movement and improved air sealing, what should be applied around the piston O ring?

- A. a VERY THICK LAYER of grease
- B. a VERY THIN LAYER of grease**
- C. a VERY THICK LAYER of locktite
- D. a VERY THIN LAYER of locktite
- E. a VERY THICK LAYER of glue
- F. a VERY THIN LAYER of glue
- G. None of the choices.

Airsoft Certification AEG01 V1 – Part II - Answers

Question 43:

Which of the following statements are generally true (choose all that apply):

- A. Do NOT apply grease on ball bearings.**
- B. Do NOT apply grease on motor bushings.**
- C. Do NOT apply silicon oil spray on ball bearings.
- D. Do NOT apply silicon oil spray on motor bushings.
- E. None of the choices.

Airsoft Certification AEG01 V1 – Part II - Answers

Question 44:

Which of the following statements do not describe totally incorrect concepts (choose all that apply):

- A. You may apply a thin layer of grease on the tappet plate where the air nozzle is installed. No grease should be applied on the air nozzle though.**
- B. You may apply a thin layer of grease on the tappet plate where the air nozzle is installed. Also have a little bit of grease applied on the air nozzle opening.
- C. The switch plate has to be greased.
- D. You should always block the opening of the cylinder.

Airsoft Certification AEG01 V1 – Part II - Answers

Question 45:

Refer to the exhibit below:

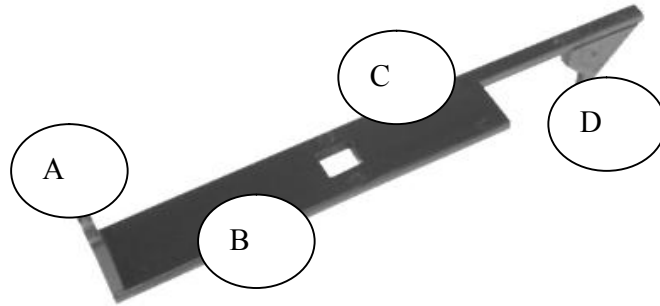

Which part of this component will interface with the delayer directly?

- A. Part A
- B. Part B
- C. Part C
- D. Part D**
- E. None of the choices.

Airsoft Certification AEG01 V1 – Part II - Answers

Question 46:

Which of the following AEG models make use of the “adjustment by lever” type of hopup mechanisms (choose all that apply):

- A. TM MP5**
- B. UTG MP5**
- C. TM G3 SAS
- D. CA G36
- E. ICS M4
- F. None of the choices.

Airsoft Certification AEG01 V1 – Part II - Answers

Question 47:

Which of the following AEG models make use of a fixed hopup mechanism (choose all that apply):

- A. TM FAMAS
- B. UTG AK
- C. Academy L85**
- D. CA AUG
- E. ICS MP5
- F. None of the choices.

Airsoft Certification AEG01 V1 – Part II - Answers

Question 48:

Which of the following AEG gun models has the shortest inner barrel?

- A. FAMAS
- B. G3 SG1
- C. MP5 RAS
- D. M4
- E. MP7**
- F. None of the choices.

Airsoft Certification AEG01 V1 – Part II - Answers

Question 49:

Refer to the exhibit below:



The stock shown belongs to:

- A. FAMAS
- B. PSG-1
- C. MP5**
- D. M4
- E. MP7
- F. AK47
- G. None of the choices.

Airsoft Certification AEG01 V1 – Part II - Answers

Question 50:

Refer to the exhibit below:



The item shown belongs to:

- A. FAMAS
- B. PSG-1
- C. MP5
- D. M4
- E. MP7
- F. AK47**
- G. None of the choices.

Airsoft Certification AEG01 V1 – Part II - Answers

Question 51:

Refer to the exhibit below:



The component shown is commonly found in which of the following mechbox versions?

- A. V1
- B. V2
- C. V3**
- D. V2 and V3
- E. V1 and V2
- F. V1 and V3
- G. None of the choices.

Airsoft Certification AEG01 V1 – Part II - Answers

Question 52:

Refer to the exhibit below:



The component shown is essential for which of the following purposes?

- A. select fire**
- B. hopup
- C. barrel tuning
- D. piston adjustment
- E. None of the choices.

Airsoft Certification AEG01 V1 – Part II - Answers

Question 53:

Refer to the exhibit below:

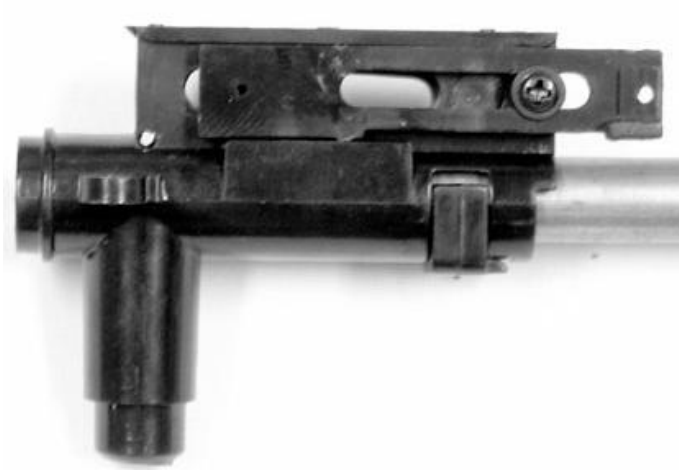

The component shown is commonly found in which of the following AEG models?

- A. **AK47**
- B. MP5
- C. G36
- D. SG552
- E. M4
- F. None of the choices.

Airsoft Certification AEG01 V1 – Part II - Answers

Question 54:

Refer to the exhibit below:

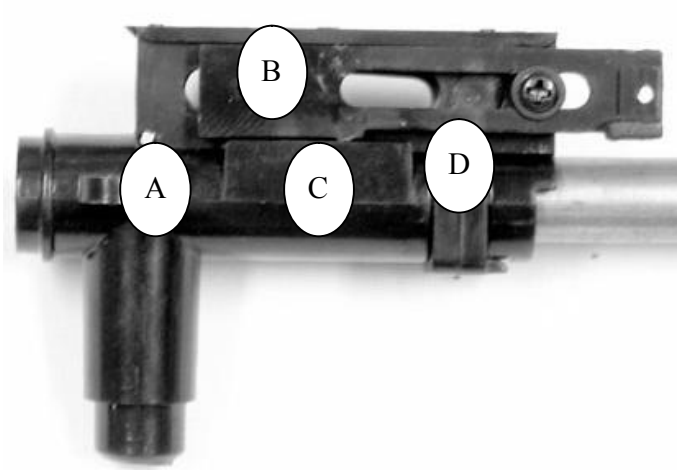

The inner barrel has its opening (for hopup) located at:

- A. Part A
- B. Part B
- C. Part C
- D. Part D**

Airsoft Certification AEG01 V1 – Part II - Answers

Question 55:

Refer to the exhibit below:

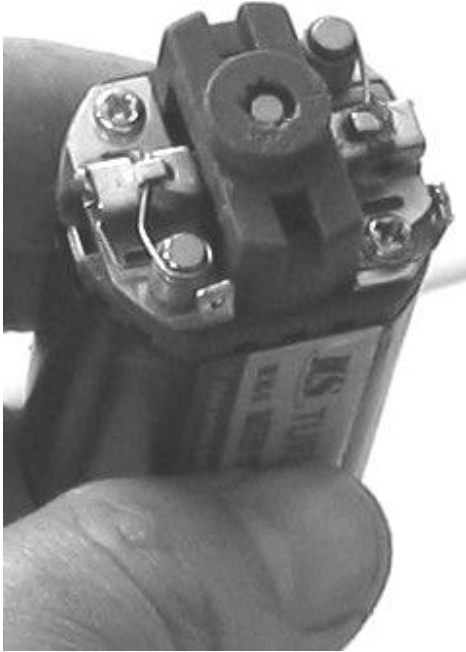

Which parts of the motor shown are practically replaceable for performance maintenance (choose all that apply):

- A. brushes**
- B. springs for the brushes**
- C. pinion
- D. shell
- E. None of the choices.

Airsoft Certification AEG01 V1 – Part II - Answers

Question 56:

Refer to the exhibit below:

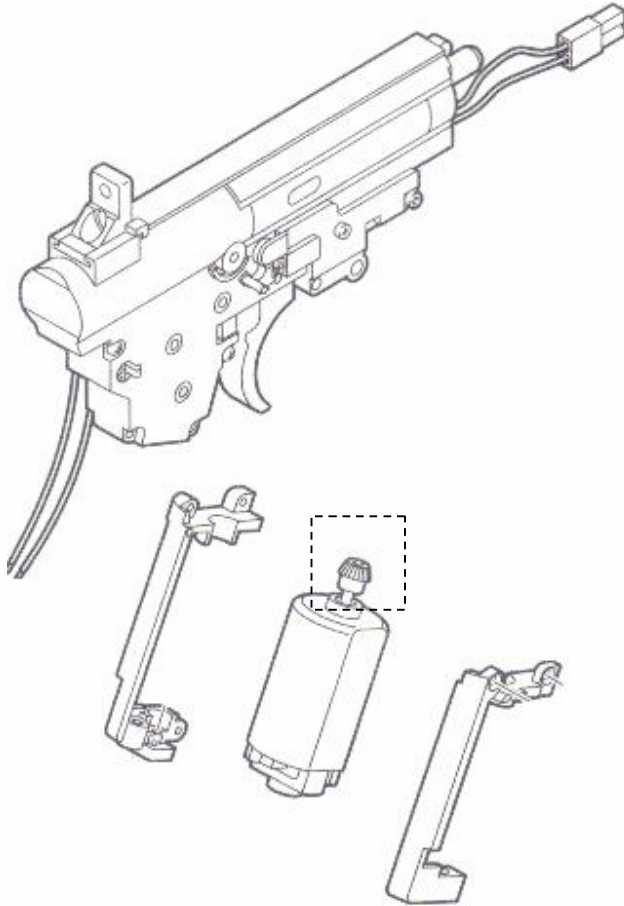

Do you need a spring in the marked location?

- A. **Yes**
- B. No
- C. Yes only for the AUG
- D. Yes only for the AUG and the AK
- E. None of the choices.

Airsoft Certification AEG01 V1 – Part II - Answers

Question 57:

Refer to the exhibit below:

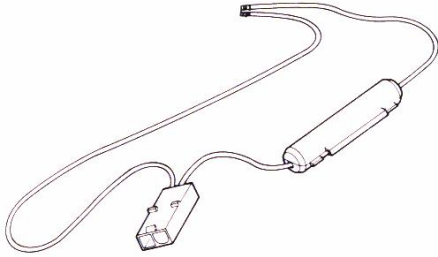

What kind of fuse come stock with most TM AEG models?

- A. 10A
- B. 15A**
- C. 20A
- D. 25A
- E. 30A
- F. None of the choices.

Airsoft Certification AEG01 V1 – Part II - Answers

Question 58:

Refer to the exhibit below:



What component is this?

- A. spacer for use in the TM piston**
- B. spacer for use in the CA piston
- C. spacer for use in the ICS piston
- D. spacer for use in the UTG piston
- E. hopup bucking
- F. pistol grip spacer
- G. None of the choices.

Airsoft Certification AEG01 V1 – Part II - Answers

Question 59:

Refer to the exhibit below:



What component is this?

- A. metal gear for use in the piston**
- B. sector gear delayer
- C. spur gear adjuster
- D. bevel gear adjuster
- E. anti reversal
- F. None of the choices.

Airsoft Certification AEG01 V1 – Part II - Answers

Question 60:

Refer to the exhibit below:

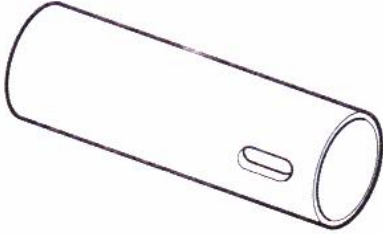

On a MP5K why would you want to block the cylinder opening on the side altogether?

- A. for better air sealing
- B. for higher ROF
- C. for higher FPS
- D. for battery power conservation
- E. None of the choices.**

Airsoft Certification AEG01 V1 – Part II - Answers

Question 61:

Refer to the exhibit below:

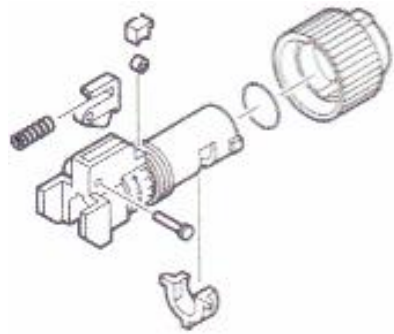

The kind of hopup mechanism shown is commonly found in which of the following AEG models (choose all that apply):

- A. AK47
- B. MP5
- C. G36**
- D. M4
- E. None of the choices.

Airsoft Certification AEG01 V1 – Part II - Answers

Question 62:

Refer to the exhibit below:



The kind of battery shown is designed primarily for which of the following AEG models (choose all that apply):

- A. AK47
- B. MP5
- C. G36
- D. M4
- E. AUG**
- F. MP5K
- G. None of the choices.

Airsoft Certification AEG01 V1 – Part II - Answers

Question 63:

For FPS measurement to deliver fairer results, one should REQUIRE (choose all that apply):

- A. all participating guns to use BBs of the same class**
- B. all participating guns have hopup completely released**
- C. mandatory greasing of all inner barrels
- D. mandatory greasing of all gears
- E. None of the choices.

Airsoft Certification AEG01 V1 – Part II - Answers

Question 64:

Which of the following formulas is related to the calculation of FPS, MPS, Joule, and the like?

$$E = \frac{1}{2} * m * Vx^2$$

$$E = 2 * m * Vx^2$$

$$E = \frac{1}{2} * m * Vx^m$$

- A. **the first one**
- B. the second one
- C. the third one
- D. None of the choices.

Airsoft Certification AEG01 V1 – Part II - Answers

Question 65:

To translate FPS into MPS, what conversion rate should you use?

- A. approx 3.28**
- B. approx 3.1
- C. approx 3.02
- D. approx 2.28
- E. approx 3.98
- F. None of the choices.

Airsoft Certification AEG01 V1 – Part II - Answers

Question 66:

Refer to the exhibit below:

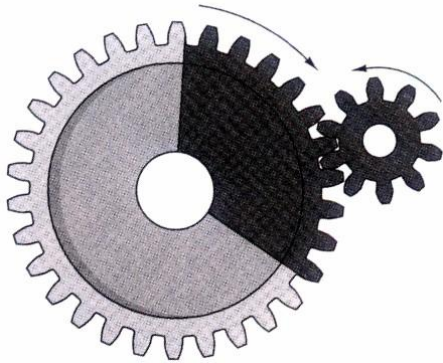

The above shows a gear ratio of:

- A. 3:1**
- B. 4:1
- C. 5:1
- D. 6:1
- E. 3.5:1
- F. 2.5:1
- G. None of the choices.

Airsoft Certification AEG01 V1 – Part II - Answers

Question 67:

Refer to the exhibit below:



Which of the following correctly describe a possible drawback of the use of the gear shown?

- A. difficulty in setup and configuration**
- B. compatibility with motor pinion
- C. compatibility with gear shim sets
- D. poorer ROF
- E. poorer FPS
- F. None of the choices.

Airsoft Certification AEG01 V1 – Part II - Answers

Question 68:

You NEED 7mm bushings as they offer relatively higher level of tolerance for radial and axial loads, thus being able to improve reliability.

- A. true if you are to go for a high FPS – high ROF configuration**
- B. true if you are to go for a high ROF – low FPS configuration
- C. true even if you are to stay with the stock configuration
- D. false

Airsoft Certification AEG01 V1 – Part II - Answers

Question 69:

The process of grounding the ends of an AEG spring is known as:

- A. Grinding**
- B. Flooring
- C. Leveling
- D. Accelerating
- E. None of the choices.

Airsoft Certification AEG01 V1 – Part II - Answers

Question 70:

Which of the following elements of a spring refers to the distance, center to center, between two coils?

- A. pitch**
- B. rate
- C. level
- D. sections
- E. None of the choices.

Airsoft Certification AEG01 V1 – Part II - Answers

Question 71:

Refer to the exhibit below:



The type of hopup shown is primarily in use by which AEG model (choose all that apply):

- A. AK47
- B. MP5
- C. G36
- D. M4**
- E. AUG
- F. MP5K
- G. None of the choices.

Airsoft Certification AEG01 V1 – Part II - Answers

Question 72:

Which of the following AEG models has the upper receiver pin tab holder breakage problem?

- A. AK47
- B. MP5
- C. G36
- D. M4**
- E. AUG
- F. MP5K
- G. None of the choices.

Airsoft Certification AEG01 V1 – Part II - Answers

Question 73:

Refer to the exhibit below:

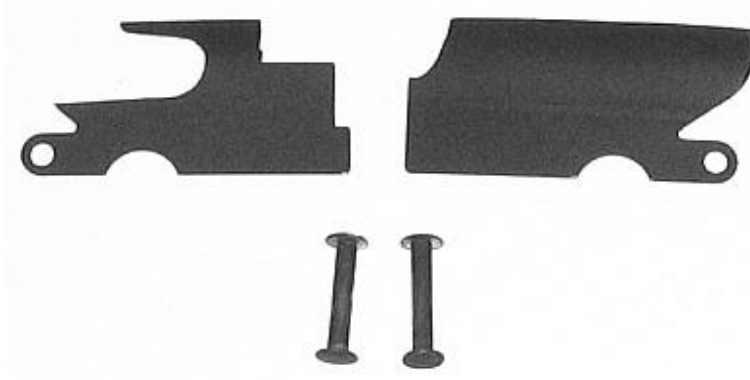

The parts shown would be useful primarily for reinforcing which of the following AEG models (choose all that apply):

- A. AK47
- B. MP5
- C. G36
- D. M4**
- E. P90
- F. G3
- G. None of the choices.

Airsoft Certification AEG01 V1 – Part II - Answers

Question 74:

Refer to the exhibit below:

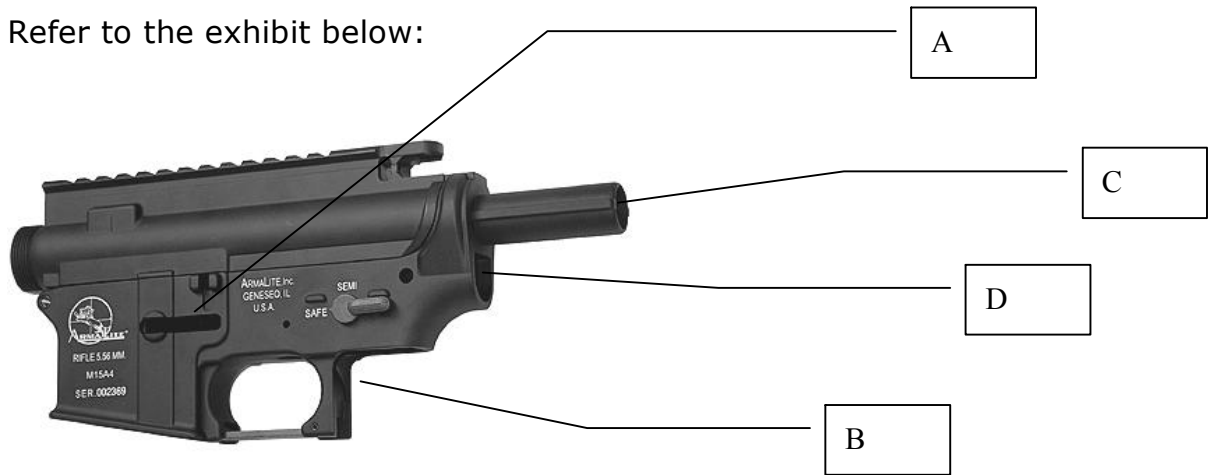

If you are to host an external battery bag at the butt, from where should you route the wires through (choose the single BEST answer):

- A. Part A
- B. Part B
- C. Part C
- D. Part D**
- E. None of the choices.

Airsoft Certification AEG01 V1 – Part II - Answers

Question 75:

A "twang" sound when firing could indicate what potential problems (choose all that apply):

- A. gears that are too dry**
- B. improper gear alignment**
- C. poor shimming**
- D. improper gear positioning**
- E. improper wiring
- F. improper hopup tuning
- G. None of the choices.

Airsoft Certification AEG01 V1 – Part II - Answers

Question 76:

Refer to the exhibit below:



Can you test fire the unit immediately by connecting the battery, assuming the mechbox has already been properly configured?

A. Yes you can

- B. No you must first put the mechbox back into the lower receiver
- C. No you must first setup the select fire unit
- D. No you must first change the battery plug to a Deans plug
- E. No you must first burn in the motor

Airsoft Certification AEG01 V1 – Part II - Answers

Question 77:

Refer to the exhibit below:



The mechbox shown is in use by which AEG model (choose all that apply):

- A. The TM M4
- B. The CA M15
- C. The G&G M4
- D. The Cybergun M4**
- E. None of the choices.

Airsoft Certification AEG01 V1 – Part II - Answers

Question 78:

A spring that is too soft can disrupt the gear timing mechanism (choose the single BEST answer):

- A. True**
- B. False
- C. True only if you use 10.8V or above.
- D. True only if you use 9.6V or above.
- E. True only if you use a fast motor like a EG1000.

Airsoft Certification AEG01 V1 – Part II - Answers

Question 79:

Refer to the exhibit below:



As recommended by the manufacturer, the tighter coils are to be fitted to which side of the mechbox?

- A. the side close to the butt**
- B. the side close to the air nozzle
- C. it does not matter at all
- D. there has been no guidelines issued in this regard

Airsoft Certification AEG01 V1 – Part II - Answers

Question 80:

Rate this comment: Different piston models may have slightly different inner diameters.

- A. True**
- B. False
- C. True only for metallic pistons.
- D. True only for plastic pistons.
- E. True only for made in China pistons.